

FR 5210

SLIDE TYPE:	Heavy-Duty Full-Extension Ball Bearing Drawer Slide
MOUNTING:	Side Mount

WIDTH:	12.9 mm (0.51 in.)
LOAD CAPACITY:	dynamic up to 90 kg (200 lbs.)



MATERIAL: cold rolled steel

FEATURES: steel ball bearings

SPECIFICATIONS:

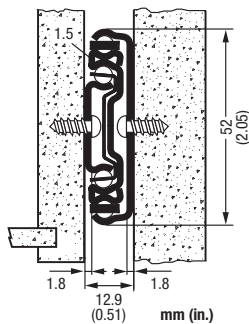

12.9 mm (0.51 in.) is the actual size of the slide. Allow a min. of 13 mm (0.51 in.) for clearance and a maximum of 13.5 mm (0.53 in.).

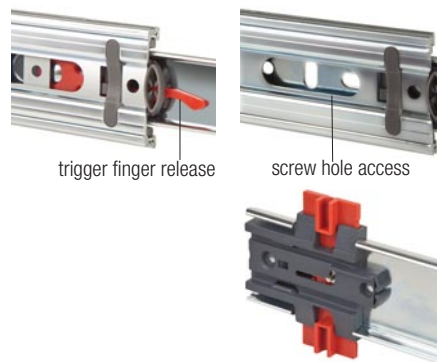

- ▶ precision ball bearing drawer slide for heavy-duty applications in office furniture, architectural millwork and institutional applications
- ▶ drawer profile features an easy to operate disconnect finger release trigger
- ▶ system 32 compatible hole locations
- ▶ drawer slide is non-handed, and has a hold-close detent
- ▶ over-extension of 25mm (1 in.) is standard

OPTION:

- ▶ also available FR 5210.ECD dynamic up to 90kg (200 lbs.) with ECD Easy Close Device

Also available with interlock & anti-tilt closing mechanism as FR 5219.

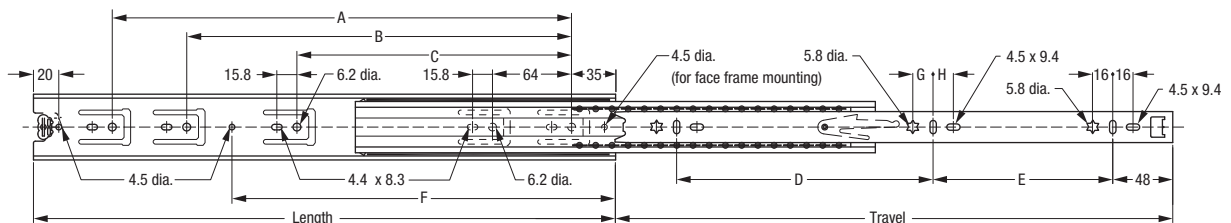

Length mm	Travel in	Cabinet Profile:				Drawer Profile:				Weight kg	Weight lbs	Order No.			
		A	B	C	F	D	E	G	H			black	zinc		
250	9.84	275	10.83	160	6.30	160	6.30			*	*	400169			
300	11.81	325	12.80	192	7.56	192	7.56	16	0.63	16	0.63	*	400181 400170		
350	13.78	375	14.76	224	8.82	160	6.30	96	3.78	16	0.63	16	0.63	*	400182 400171
400	15.75	425	16.73	320	12.60	160	6.30	128	5.04	16	0.63	16	0.63	*	400183 400172
450	17.72	475	18.70	352	13.86	192	7.56	160	6.30	16	0.63	16	0.63	*	400184 400173
500	19.69	525	20.67	416	16.38	224	8.82	192	7.56	16	0.63	16	0.63	*	400185 400174
550	21.65	575	22.64	448	17.64	224	8.82	224	8.82	16	0.63	16	0.63	*	400186 400175
600	23.62	625	24.61	480	18.90	288	11.34	224	8.82	16	0.63	16	0.63	*	400187 400176
650	25.59	675	26.58	544	21.42	288	11.34	256	10.08	16	0.63	16	0.63	*	400188 400178
700	27.56	725	28.54	576	22.68	352	13.86	256	10.08	16	0.63	16	0.63	*	400189 400179

Packing Unit: Lengths 250mm through 450mm 10 pair per box. Lengths 500mm and 550mm 8 pair per box. Lengths 600mm through 700mm 6 pair per box * on request