

FR 5050.OT.SB

SLIDE TYPE: Heavy-Duty Full-Extension Ball Bearing Drawer Slide, Over-travel Version, Standard Bayonet Mount
MOUNTING: Side Mount

WIDTH: 12.5 mm (0.49 in.)
LOAD CAPACITY: dynamic up to 60 kg (130 lbs.)

New Product
 Please inquire for lead time



MATERIALS: cold rolled steel

FEATURES: steel ball bearings

SPECIFICATIONS:

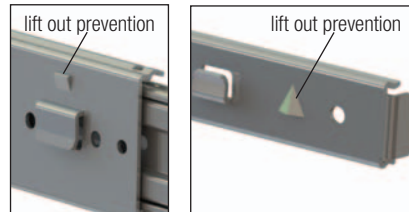
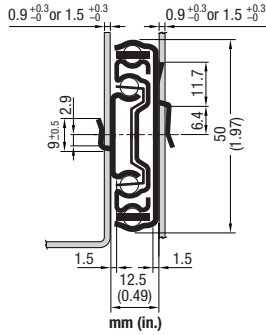

- ▶ bayonet features for fast and easy mounting of slide to cabinet and drawer to slide
- ▶ middle profile form provides additional stability
- ▶ precision ball bearing drawer slide for heavy-duty applications with **with 25 mm (.98 inch) over-travel**
- ▶ drawer profile features an easy to operate disconnect finger release trigger
- ▶ hold-close detent
- ▶ lift out prevention

12.5 mm (0.49 in.) is the actual size of the slide. Allow a min. of 12.8 mm (0.50 in.) for clearance and a maximum of 13.0 mm (0.51 in.).

Installation Dimensions

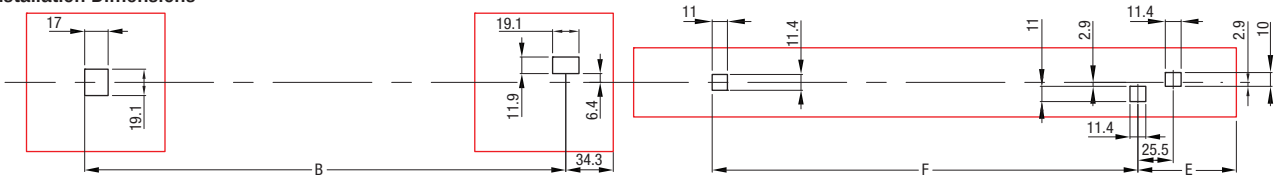

Slide Dimensions

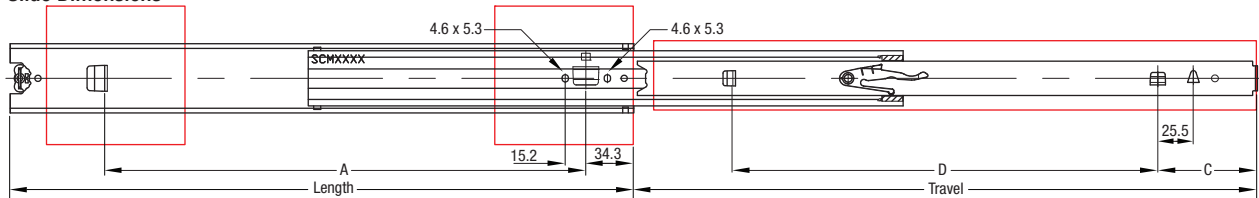

Length	Travel	Cabinet Profile:				Drawer Profile:				Weight	Order No.							
		A	B	C	D	E	F	1.5mm 16ga. steel	.9mm 20ga. steel									
mm	in	mm	in	mm	in	mm	in	mm	in	mm	in	zinc	zinc					
400	15.75	425	16.73	317.5	12.50	317.5	12.50	58.4	2.30	273.0	10.75	58.4	2.30	273.0	10.75	*	*	*
450	17.72	475	18.70	347.5	13.68	347.5	13.68	71.1	2.80	307.5	12.12	71.1	2.80	307.5	12.12	*	*	*
500	19.69	525	20.67	393.7	15.50	393.7	15.50	83.8	3.30	370.0	14.57	83.8	3.30	370.0	14.57	*	*	*
550	21.66	575	22.64	445.0	17.52	445.0	17.52	109.2	4.30	420.0	16.54	109.2	4.30	420.0	16.54	*	*	*
600	23.62	625	24.61	393.7	15.50	393.7	15.50	134.6	5.30	393.7	15.50	134.6	5.30	393.7	15.50	*	*	*
650	25.59	675	26.58	393.7	15.50	393.7	15.50	160.0	6.30	393.7	15.50	160.0	6.30	393.7	15.50	*	*	*
700	27.56	725	28.54	393.7	15.50	393.7	15.50									*	*	*

Packing Unit: lengths 400 to 500 10 sets per box, lengths 550 to 700 8 sets per box

* on request