

FR 5001.SS.ECD

| | |
|--------------------|---|
| SLIDE TYPE: | Full-Extension Stainless Steel Ball Bearing Drawer Slide - with Easy Close Device |
| MOUNTING: | Side Mount |

| | |
|-----------------------|--------------------------------|
| WIDTH: | 12.7 mm (0.50 in.) |
| LOAD CAPACITY: | dynamic up to 45 kg (100 lbs.) |

Front Mounting Bracket Face Frame Rear Mounting Bracket

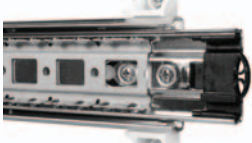
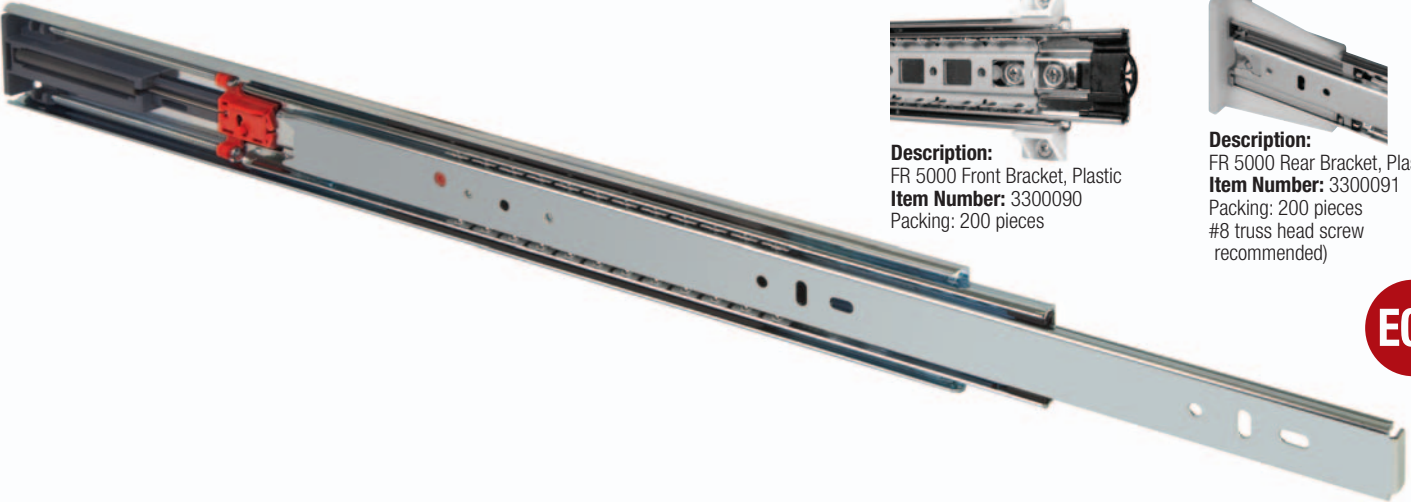

Description:
FR 5000 Front Bracket, Plastic
Item Number: 3300090
Packing: 200 pieces



Description:
FR 5000 Rear Bracket, Plastic
Item Number: 3300091
Packing: 200 pieces
#8 truss head screw recommended)



| | |
|-------------------|---------------------|
| MATERIALS: | 304 stainless steel |
|-------------------|---------------------|

| | |
|------------------|-----------------------------------|
| FEATURES: | 304 stainless steel ball bearings |
|------------------|-----------------------------------|

| | |
|------------------------|--|
| SPECIFICATIONS: | <ul style="list-style-type: none"> ▶ precision stainless steel ball bearing drawer slide for medium-duty applications in office, residential, medical, institutional, industrial and marine furniture ▶ drawer profile features an easy to operate disconnect finger release trigger ▶ system 32 compatible hole locations ▶ drawer slide is non-handed ▶ new ECD Easy Close Device |
|------------------------|--|

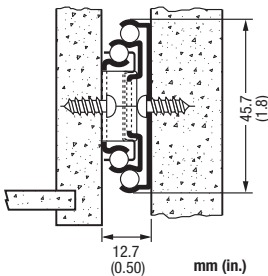

12.7 mm (0.50 in.) is the actual size of the slide. Allow a min. of 13 mm (0.51 in.) for clearance and a maximum of 13.5 mm (0.53 in.).

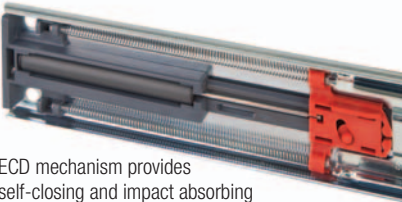
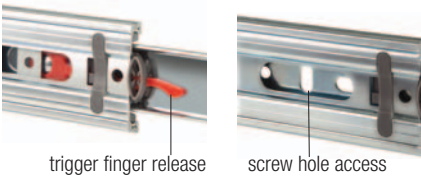

ECD mechanism provides self-closing and impact absorbing soft-close feature.

| | |
|-----------------|---|
| CAUTION: | <ul style="list-style-type: none"> ▶ Temperature range 5°C-40°C (41°F-104°F) ▶ For a rigid connection of the front and rear face frame mounting brackets we recommend the use of #8 truss head screw ▶ We do not recommend this slide to be used on drawers over 27 in. in width |
|-----------------|---|

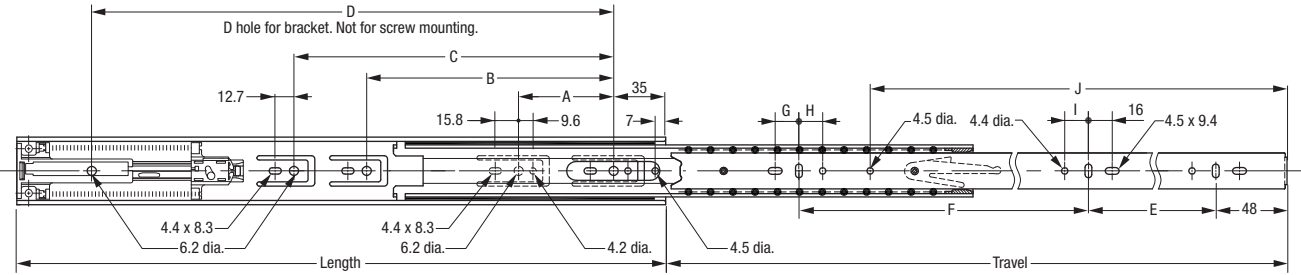

| Length | Travel | Cabinet Profile: | | | | Drawer Profile: | | | | | | Weight | Order No. | | | | | | |
|--------|--------|------------------|-------|----|------|-----------------|-------|-----|-------|-----|-------|--------|-----------|-----|------|----|------|---|---|
| | | A | B | C | D | E | F | G | H | I | J | | | | | | | | |
| mm | in | mm | in | mm | in | mm | in | mm | in | mm | in | mm | in | kg. | lbs. | | | | |
| 300 | 11.81 | 245 | 9.65 | 64 | 2.52 | | | 224 | 8.82 | | | | | 189 | 7.44 | * | * | | |
| 355 | 13.98 | 350 | 13.78 | 64 | 2.52 | 128 | 5.04 | | | 288 | 11.34 | 128 | 5.04 | | | * | * | | |
| 405 | 15.95 | 400 | 15.75 | 64 | 2.52 | 160 | 6.30 | | | 320 | 12.60 | 160 | 6.30 | | | * | * | | |
| 450 | 17.72 | 450 | 17.72 | 64 | 2.52 | 224 | 8.82 | | | 352 | 13.89 | 160 | 6.30 | | | * | * | | |
| 500 | 19.69 | 500 | 19.69 | 64 | 2.52 | 256 | 10.08 | | | 416 | 16.38 | 192 | 7.56 | 128 | 5.04 | 16 | 0.63 | * | * |
| 550 | 21.65 | 550 | 21.65 | 64 | 2.52 | 224 | 8.82 | 320 | 12.60 | 448 | 17.64 | 224 | 8.82 | 160 | 6.30 | | | * | * |
| 600 | 23.62 | 600 | 23.62 | 64 | 2.52 | 224 | 8.82 | 352 | 13.86 | 512 | 20.16 | 256 | 10.08 | 160 | 6.30 | 16 | 0.63 | * | * |
| 650 | 25.59 | 650 | 25.59 | 64 | 2.52 | 224 | 8.82 | 416 | 16.19 | 576 | 22.68 | 256 | 10.08 | 192 | 7.56 | 16 | 0.63 | * | * |
| 700 | 27.56 | 700 | 27.56 | 64 | 2.52 | 224 | 8.82 | 448 | 17.69 | 608 | 23.94 | 288 | 11.34 | 224 | 8.82 | 16 | 0.63 | * | * |

Packing Unit: 10 pair per box

* on request

