

# FR 215

<b>SLIDE TYPE:</b>	Regular-Extension Drawer Slide
<b>MOUNTING:</b>	Bottom Mount

<b>WIDTH:</b>	24 mm (0.95 in.)
<b>LOAD CAPACITY:</b>	dynamic up to 100 kg (225 lbs.)



<b>MATERIAL:</b>	powder coated cold rolled steel
------------------	---------------------------------

<b>FEATURES:</b>	Delrin* encased steel roller bearings
------------------	---------------------------------------

<b>SPECIFICATIONS:</b>
<ul style="list-style-type: none"> <li>▶ Delrin* encased roller bearings* provide excellent and quiet running even under the heaviest loads</li> <li>▶ double-sided captive profile</li> <li>▶ soft rubber back stop</li> </ul>

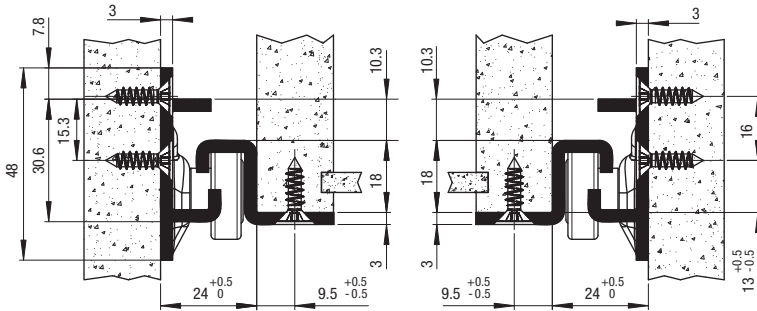

<b>NOTE:</b>
<ul style="list-style-type: none"> <li>▶ compatible with full-extension slides FR 7100 and FR 7180.</li> <li>▶ also available in stainless steel FR 215.CS</li> </ul>

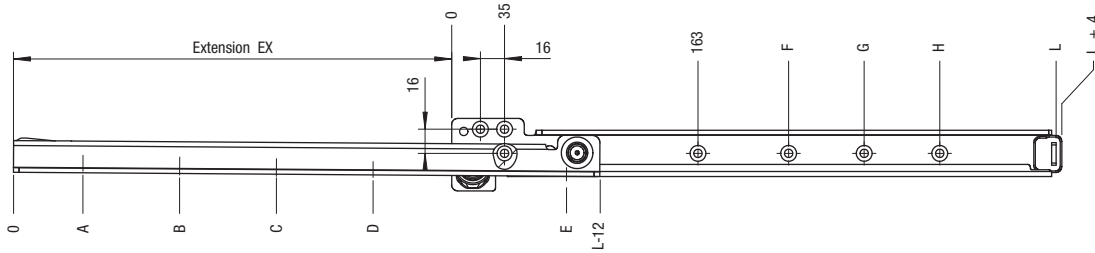

Length L		EX		A		B		C		D		E		F		G		H		Weight		Order No.
mm	in	mm	in	mm	in	mm	in	mm	in	mm	in	mm	in	mm	in	mm	in	mm	in	kg	lbs	light grey
400	15.75	290	11.42	46	1.81	238	9.37	366	14.41					323	12.72					*		*
450	17.72	340	13.39	96	3.78	288	11.34	416	16.38					355	13.98					*		*
500	19.69	390	15.35	50	1.97	146	5.75	338	13.31	466	18.35			291	11.46	451	17.76			*		4182
550	21.65	420	16.54	68	2.68	196	7.72	388	15.28	516	20.31			323	12.72	483	19.02			*		4183
600	23.62	460	18.11	54	2.13	246	9.69	438	17.42	566	22.28			355	13.98	547	21.54			*		4184
650	25.59	500	19.69	40	1.57	296	11.65	488	19.21	616	24.25			355	13.98	611	24.06			*		4185
700	27.56	540	21.26	58	2.28	186	7.32	346	13.62	538	21.18	666	26.22	355	13.98	515	20.28	643	25.31	*		4186
750	29.53	580	22.84	76	2.99	204	8.03	396	15.59	588	23.15	716	28.19	355	13.98	547	21.54	675	26.57	*		4187
800	31.50	620	24.41	62	2.44	190	7.48	446	17.56	638	25.12	766	30.16	355	13.98	611	24.06	739	29.09	*		4188
850	33.46	660	25.99	80	3.15	240	9.45	496	19.53	688	27.09	816	32.13	355	13.98	611	24.06	771	30.35	*		*
900	35.43	700	27.56	66	2.60	290	11.42	546	21.50	738	29.06	866	34.09	355	13.98	611	24.06	835	32.87	*		4190
950	37.40	740	29.13	52	2.05	340	13.39	596	23.46	788	31.02	916	36.06	355	13.98	611	24.06	899	35.39	*		*
1000	39.37	780	30.71	70	2.76	390	15.35	646	25.43	838	32.99	966	38.03	355	13.98	643	25.31	931	36.65	*		4192

Packing Unit: 5 sets per box

\* on request

\*DuPont (TM) Delrin®